

CLADDING ZONE PER DESIGN

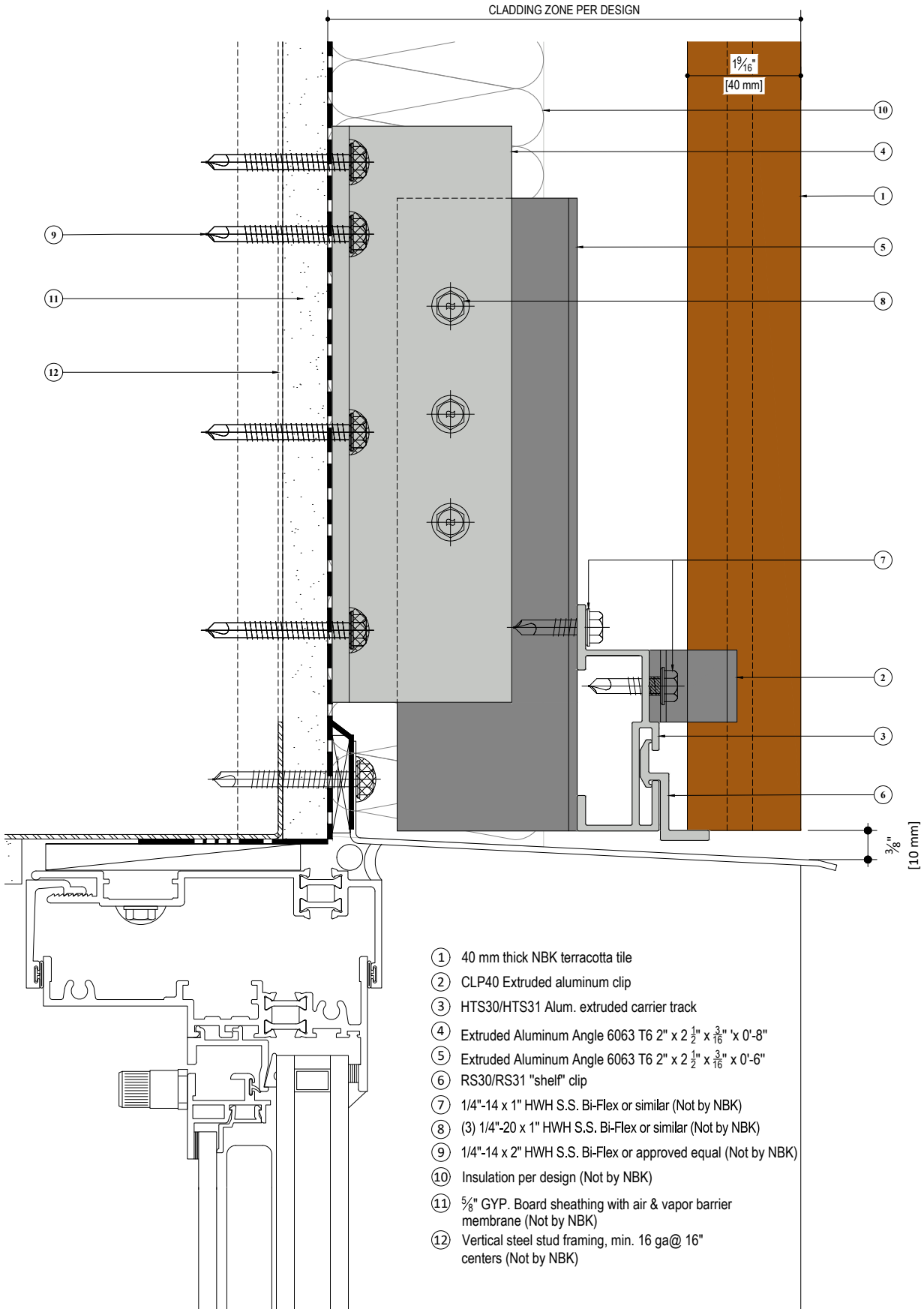

- ① 40 mm thick NBK terracotta tile
- ② CLP40 Extruded aluminum clip
- ③ HTS30/HTS31 Alum. extruded carrier track
- ④ Extruded Aluminum Angle 6063 T6 2" x 2 1/2" x 3/16" x 0'-8"
- ⑤ Extruded Aluminum Angle 6063 T6 2" x 2 1/2" x 3/16" x 0'-6"
- ⑥ RS30/RS31 "shelf" clip
- ⑦ 1/4"-14 x 1" HWH S.S. Bi-Flex or similar (Not by NBK)
- ⑧ (3) 1/4"-20 x 1" HWH S.S. Bi-Flex or similar (Not by NBK)
- ⑨ 1/4"-14 x 2" HWH S.S. Bi-Flex or approved equal (Not by NBK)
- ⑩ Insulation per design (Not by NBK)
- ⑪ 5/8" GYP. Board sheathing with air & vapor barrier membrane (Not by NBK)
- ⑫ Vertical steel stud framing, min. 16 ga @ 16" centers (Not by NBK)

SYSTEM:  
**TERRART 40**

DETAIL:  
**STANDARD STUDWALL DETAIL**

DETAIL NUMBER:  
**NBK-VS-40-11**

TILE DIRECTION:  
**VERTICAL**

DRAWING REFERENCE:  
**TYPICAL HEAD**

SCALE:  
**1:2**

**NBK** | ARCHITECTURAL  
TERRACOTTA  
A Hunter Douglas Company

**NBK North America**

10 Federal Street, Second Floor  
Salem, MA 01970  
Telephone: +1 (781) 639 2662  
www.nbkterracotta.com